

TSC

The Smarter Choice.

➤ www.tscprinters.com

TSC Droid APP Introduction

Contents

- Bluetooth Setup
- TSC Android APP Introduction
- TCP/IP Setup



TSC Droid APP on Android



- Click the TSC Utilities to run TSC APP.

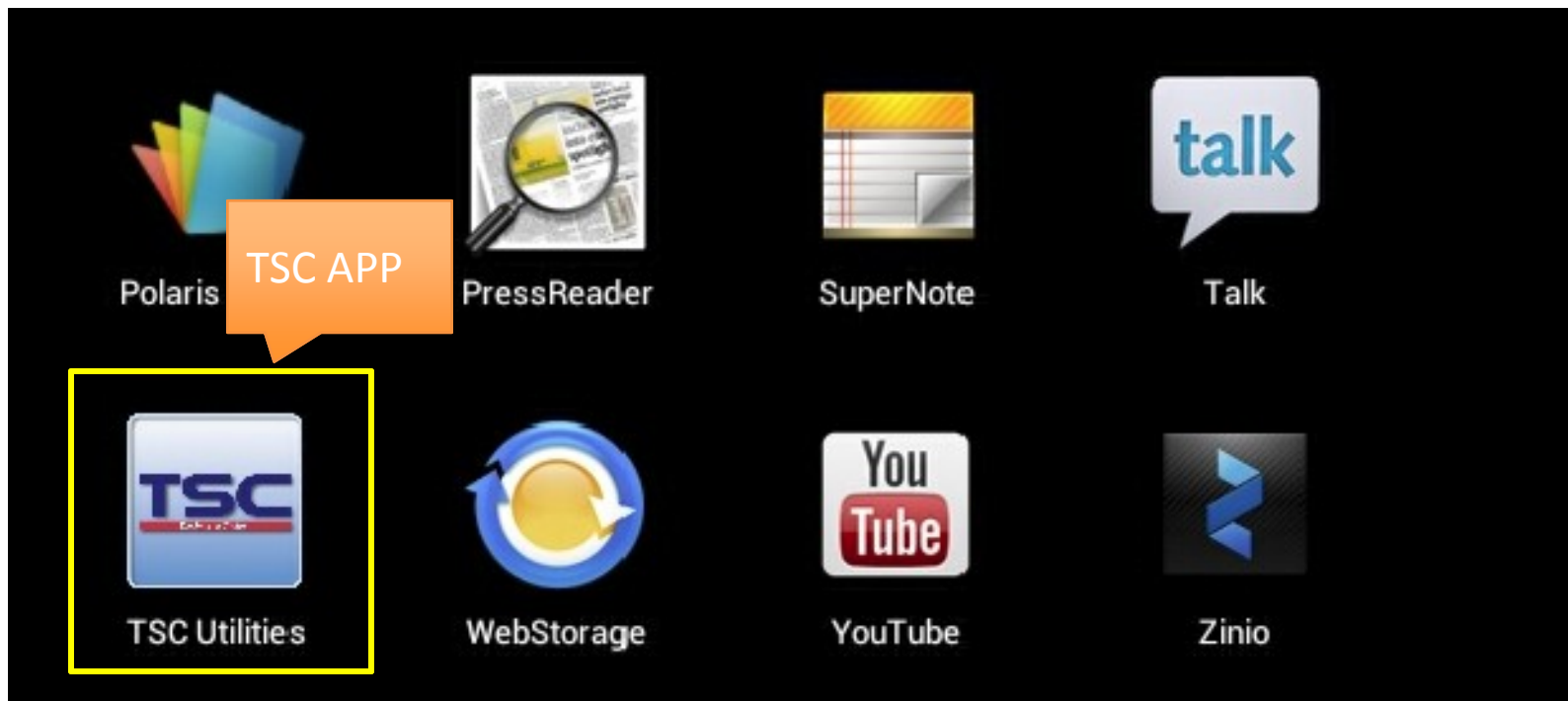

Select Connection Mode



2 connection modes in
TSC APP.

1. Bluetooth Mode

2. TCP/IP Mode

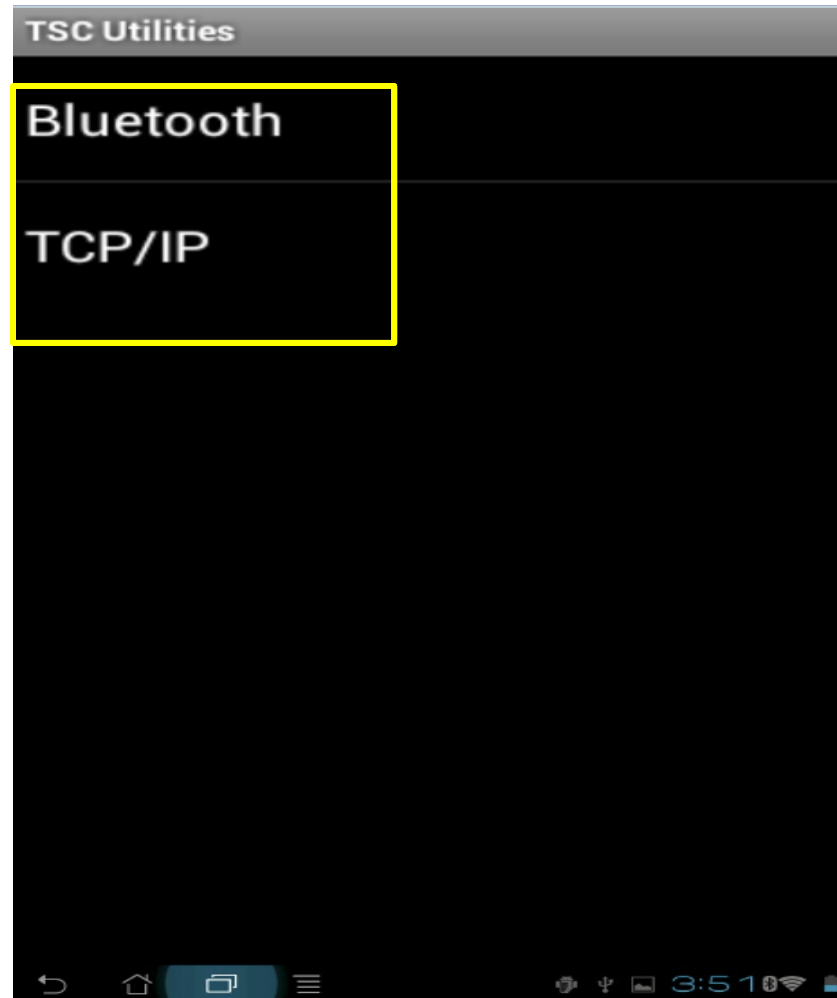



Bluetooth Setup

Bluetooth Connect Method



Need to click the “Menu” button to Connect

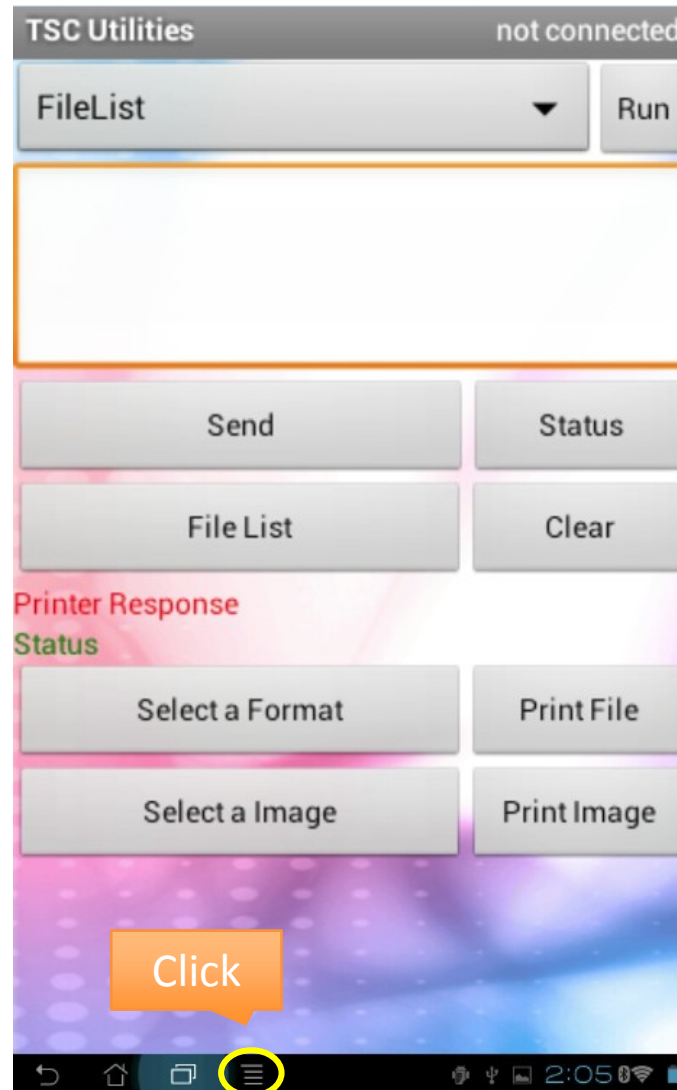

Search for the Alpha-3R



Click “Connect a device”

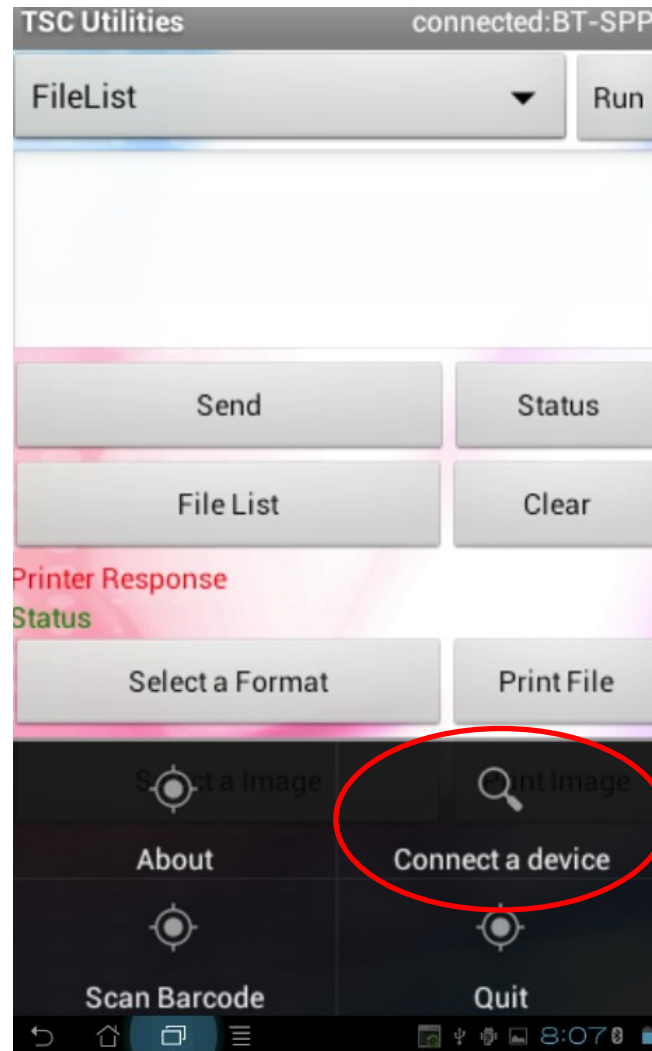

Search for Alpha-3R (Con.)



Search the Bluetooth device.

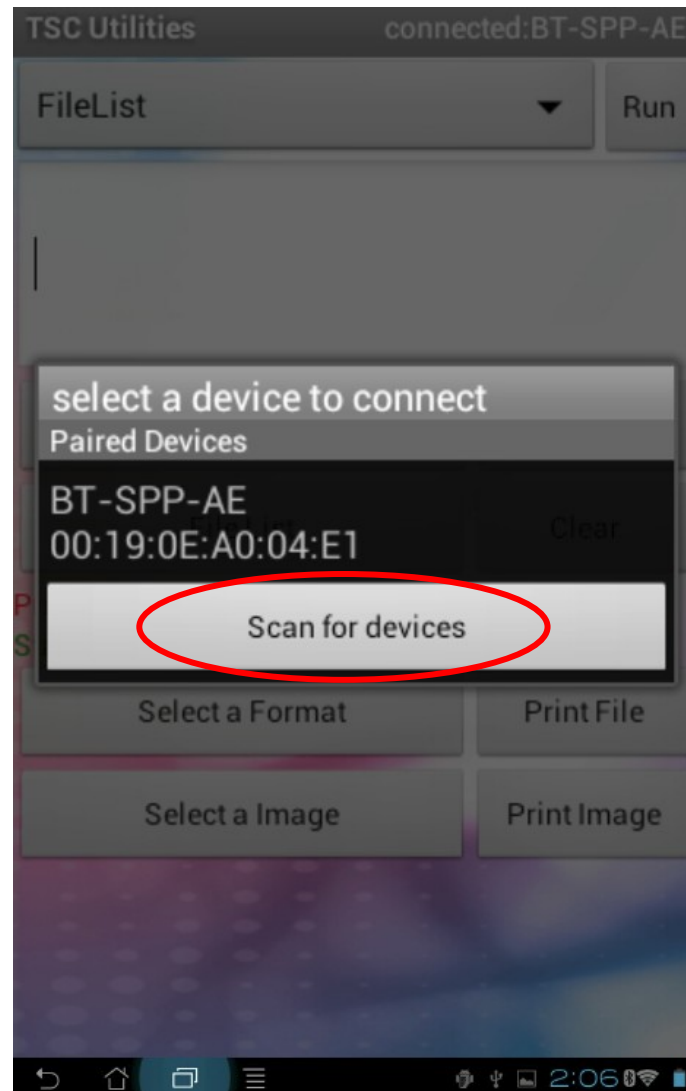

Bluetooth Pairing Request

Enter Bluetooth Pin Code
Default Pin Code is "0000"

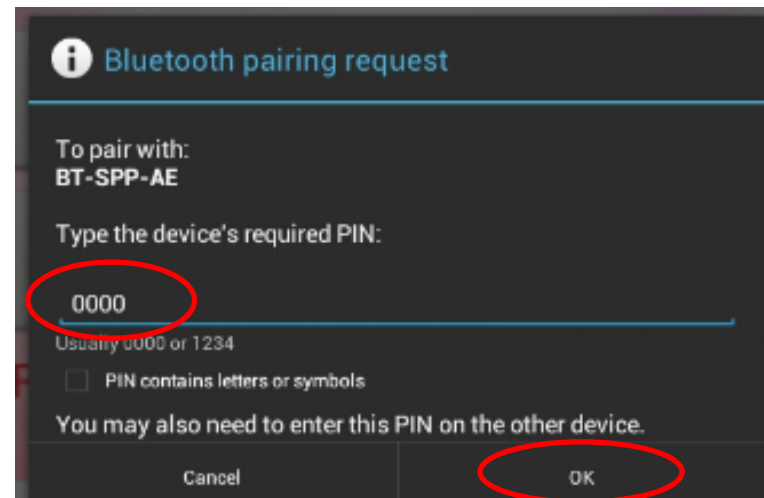
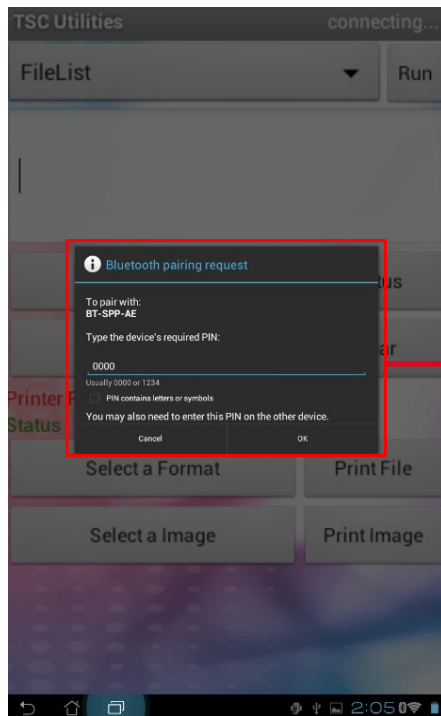

Successfully Connected

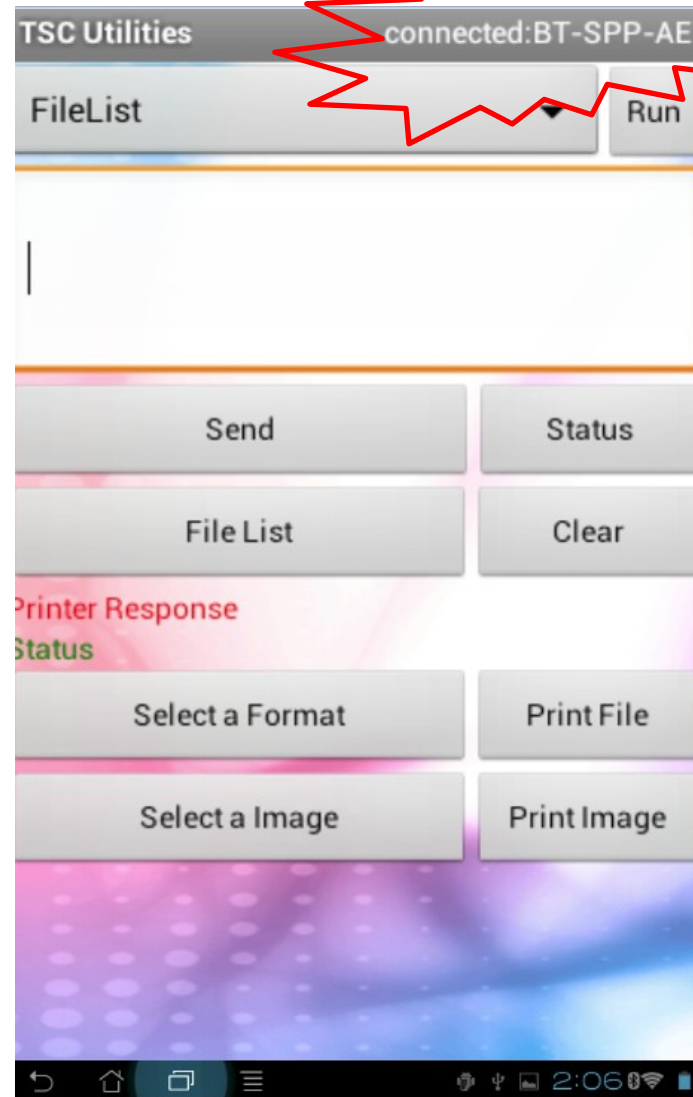

The title will show the connected device name

Successfully Connected (Con.)





Printer Status Function

Successfully Connected (Con.)



TSC Utilities connected:BT-SPP-AE

FileList ▼ Run

|

Send Status

File List Clear

Select a Format Print File

Select a Image Print Image

Ready

Click “Status” button to show the printer status

Error Handling – Head Open



Error Handling – Head Open



The Printer will show the message in red when error

TSC Utilities connected:BT-SPP-AE

FileList ▼ Run

Send Status

File List Clear

Head Open

Select a Format Print File

Select a Image Print Image

2:06



Get File List Function

Recall Label Format for Printing



Click “File List” button to receive the downloaded label format from printer

The screenshot shows the TSC Utilities mobile application interface. At the top, it says "TSC Utilities" and "connected:BT-SPP-AE". Below this is a "FileList" button with a dropdown arrow and a "Run" button. A large empty text box is below the "FileList" button. Further down are buttons for "Send", "Status", "File List" (circled in red), and "Clear". Below these are buttons for "Select a Format", "Print File", "Select a Image", and "Print Image". At the bottom, there is a "Ready" status indicator and a navigation bar with icons for back, home, and other functions. The time 2:06 is displayed in the bottom right corner.

Recall Label Format for Printing (Cont.)



Click the list box to show the downloaded file list

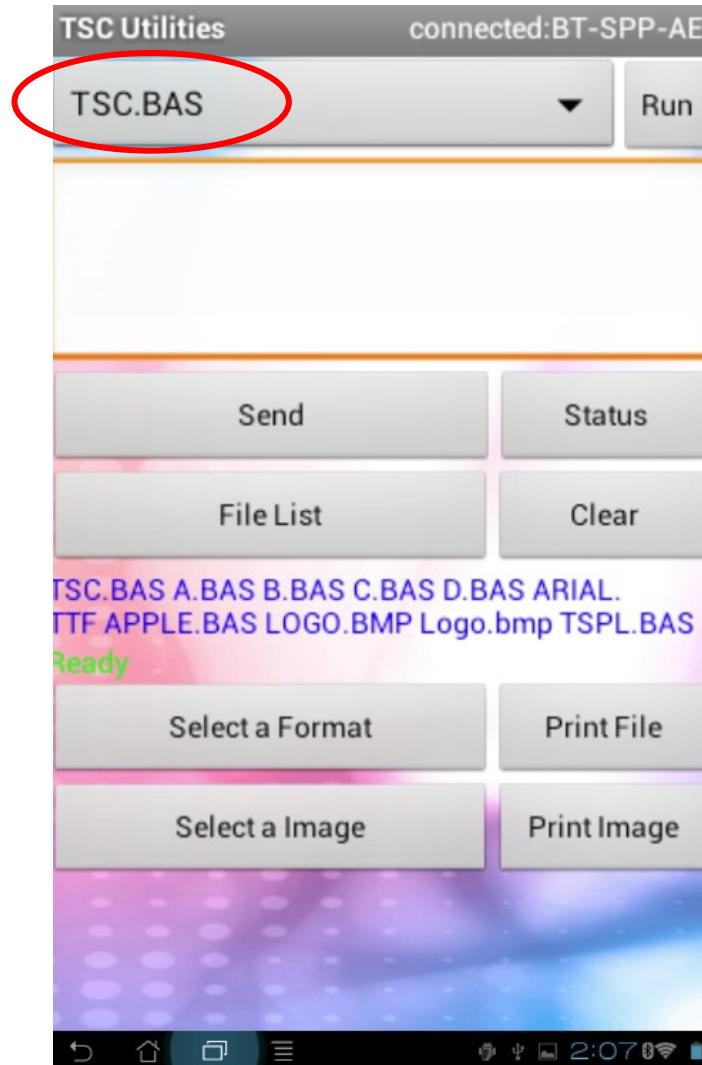

Recall Label Format for Printing (Cont.)



The dialog box only shows the .BAS file extension formats

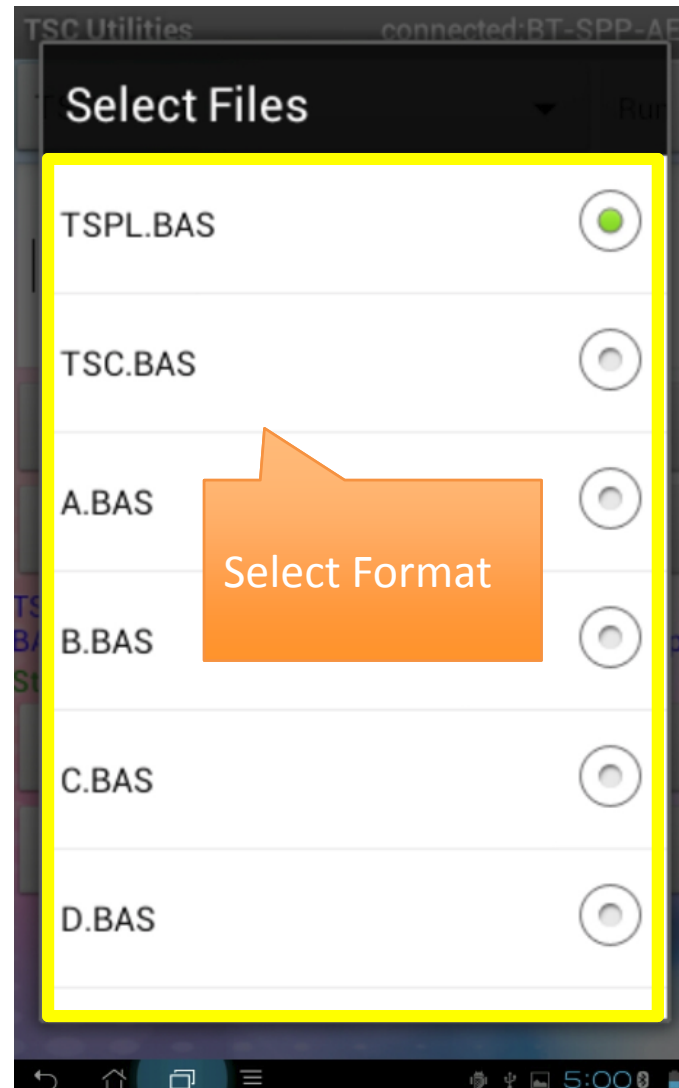

Recall Label Format for Printing (Cont.)



TSC Utilities connected:BT-SPP-AE

APPLE.BAS ▼ Run

|

Send Status

File List Clear

Ready

Select a Format Print File

Select a Image Print Image

2:08

Click the “Run” button to run this format

Recall Label Format for Printing (Cont.)



Step 1.
Input Variable

The screen will show the prompt for variable

Step 1. Input data in TextBox

Step 2. Click "Send" button to send the message to printer

5

Send

Step 2.
Send message

Please Input Weight(KG):

Input Prompt String

Recall Label Format for Printing (Cont.)



Clear Function

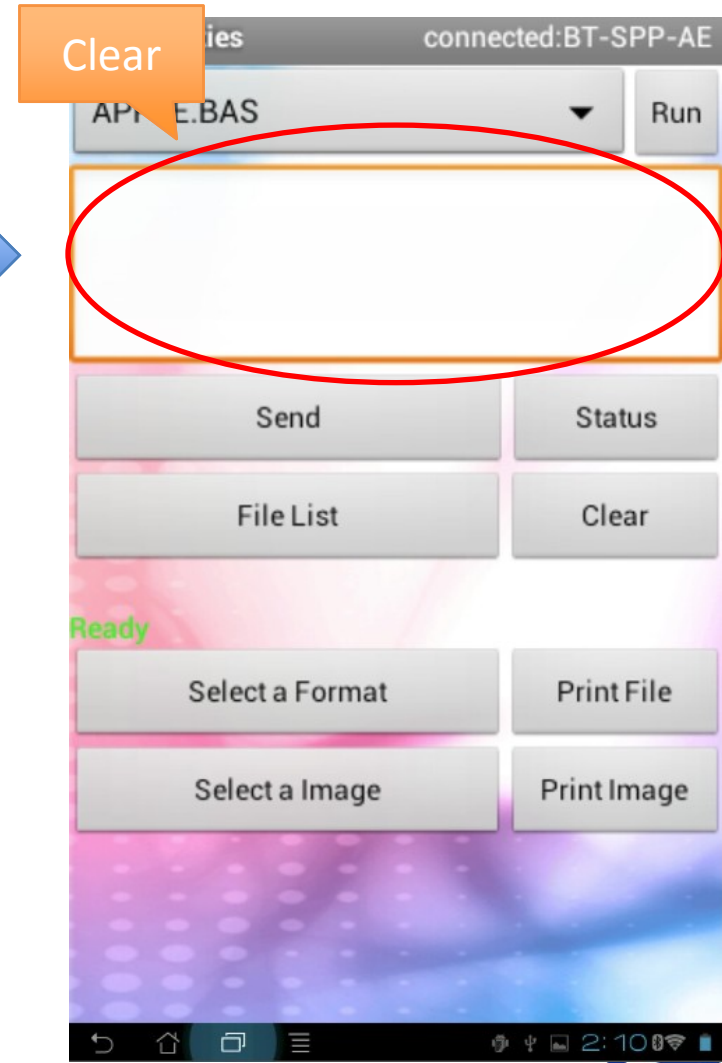
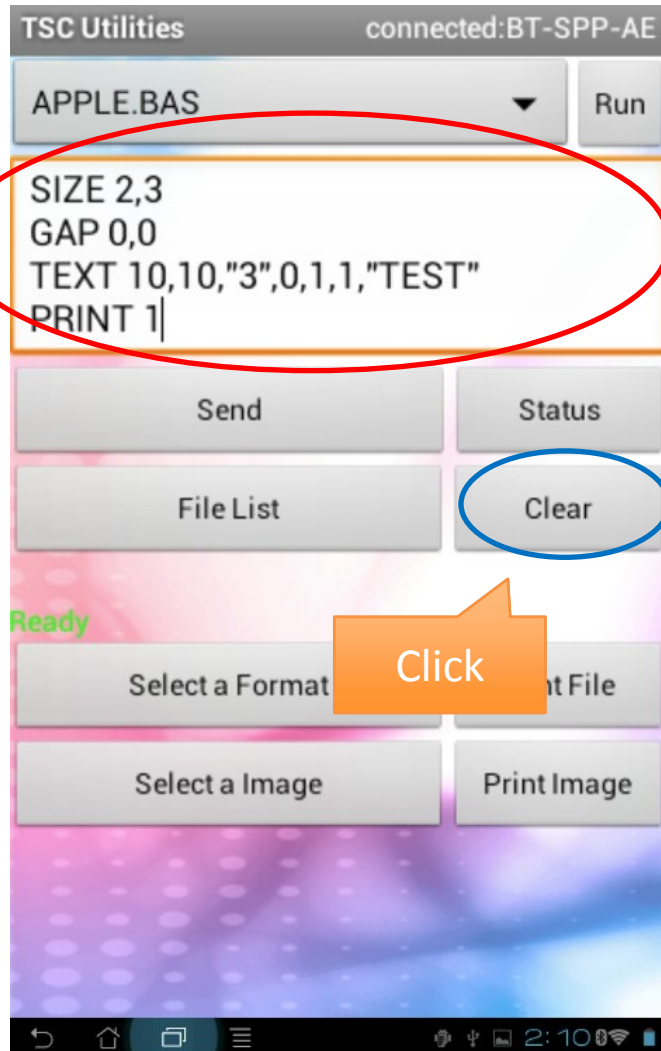



Handheld Device Data Transmission Function

Print File from Handheld Device



This function will search the *.txt file in handheld devices “/Download” folder.

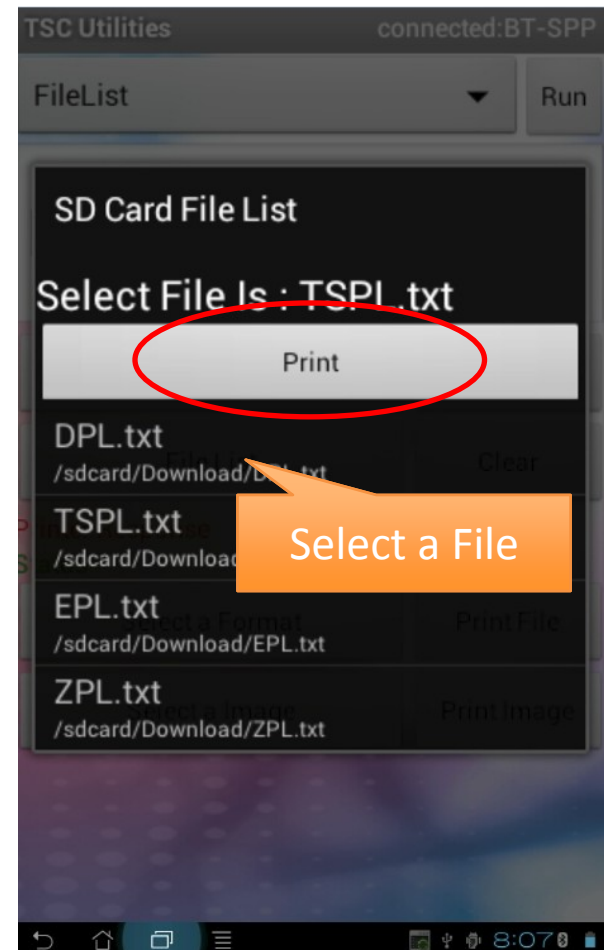
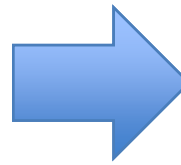
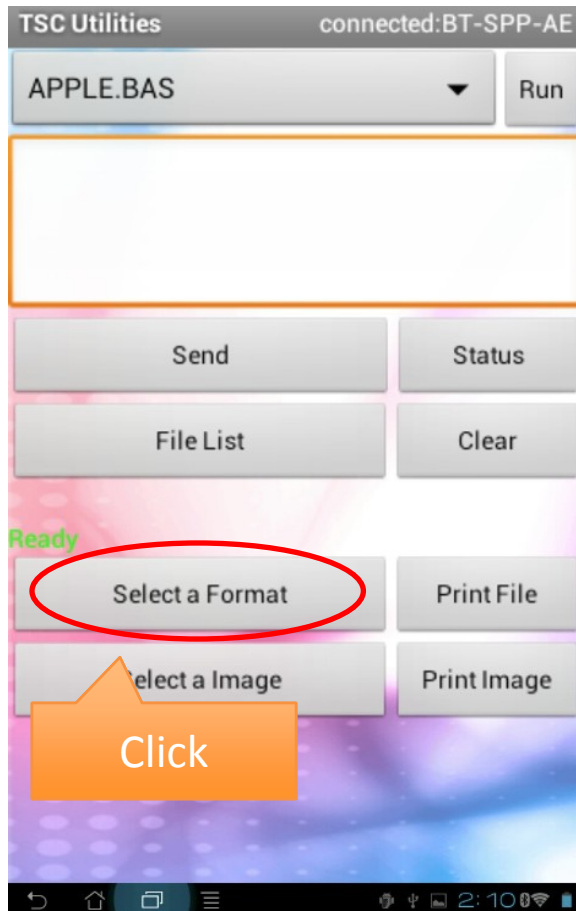

Print File from Handheld Device (Cont.)

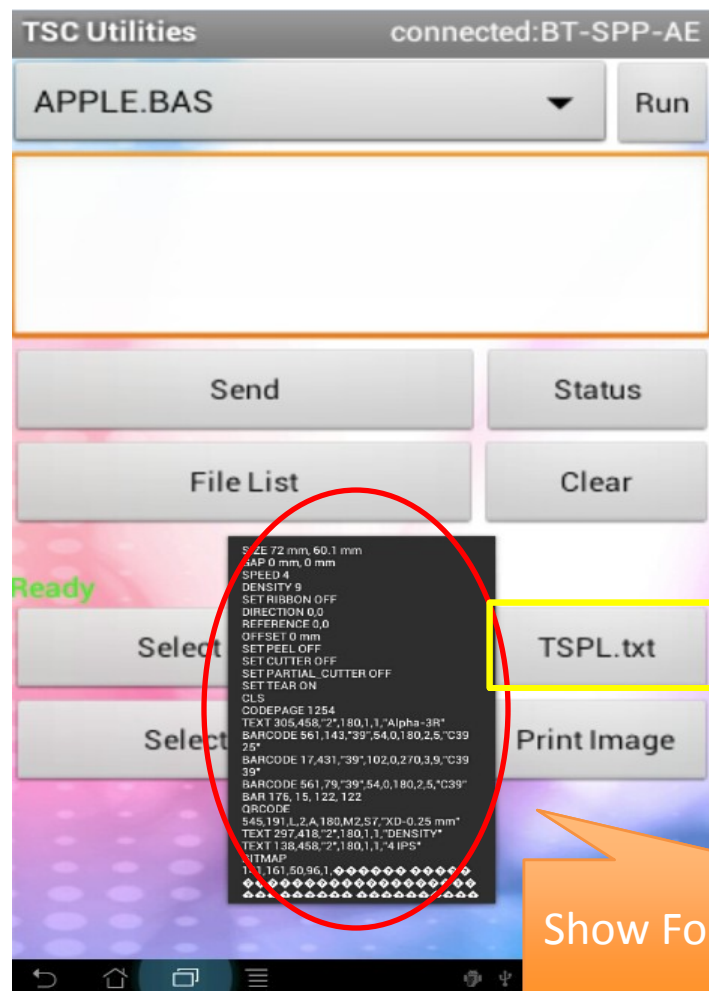

Show Format Contents



Download BMP file from Handheld Device



The function will search the *.bmp file in handheld devices “/Download” folder.

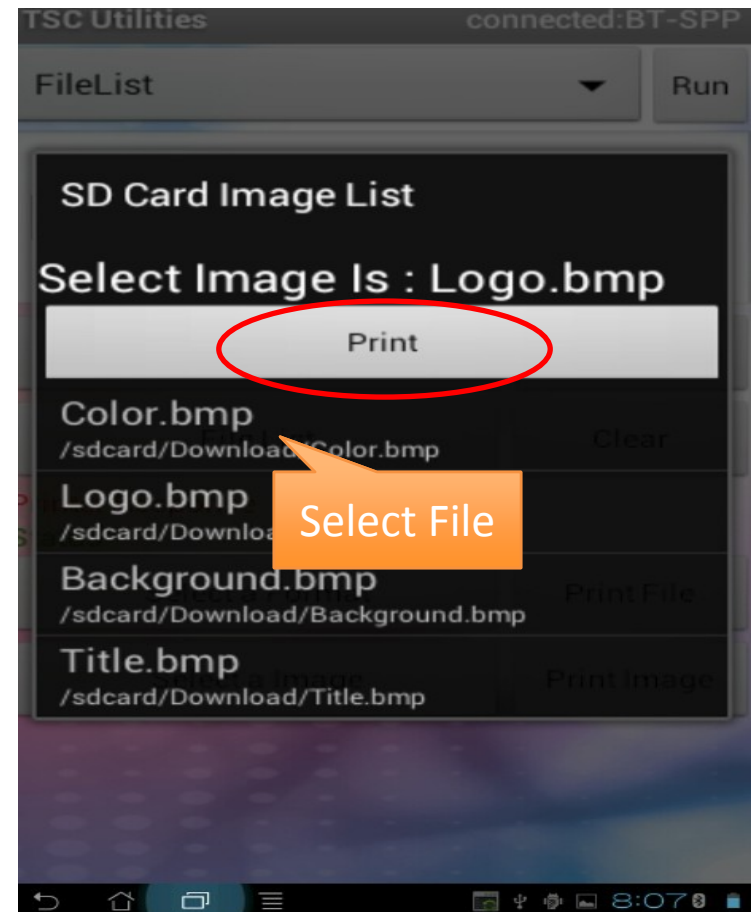
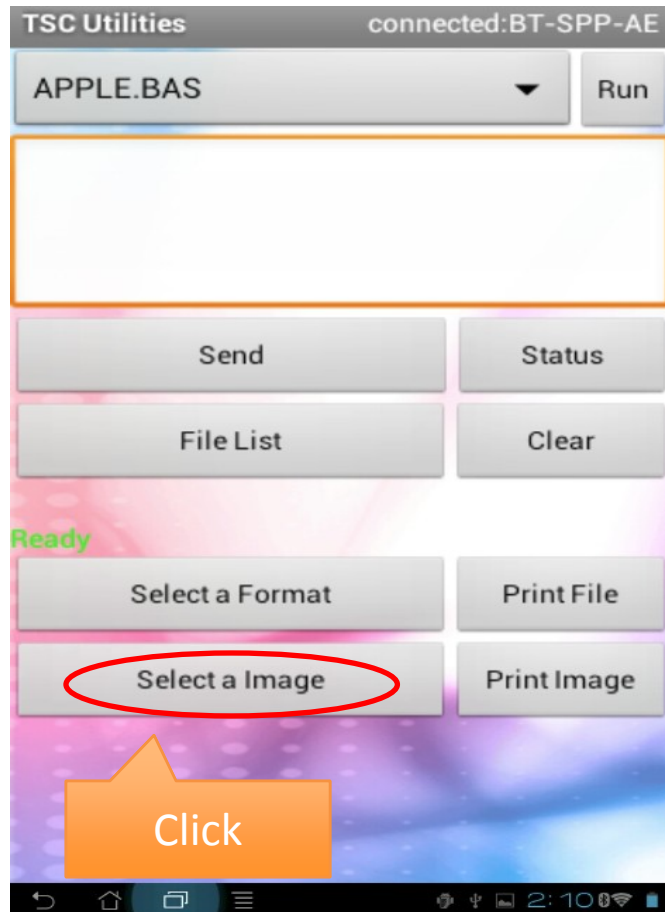

Download bmp File from Handheld Devices (Cont.)

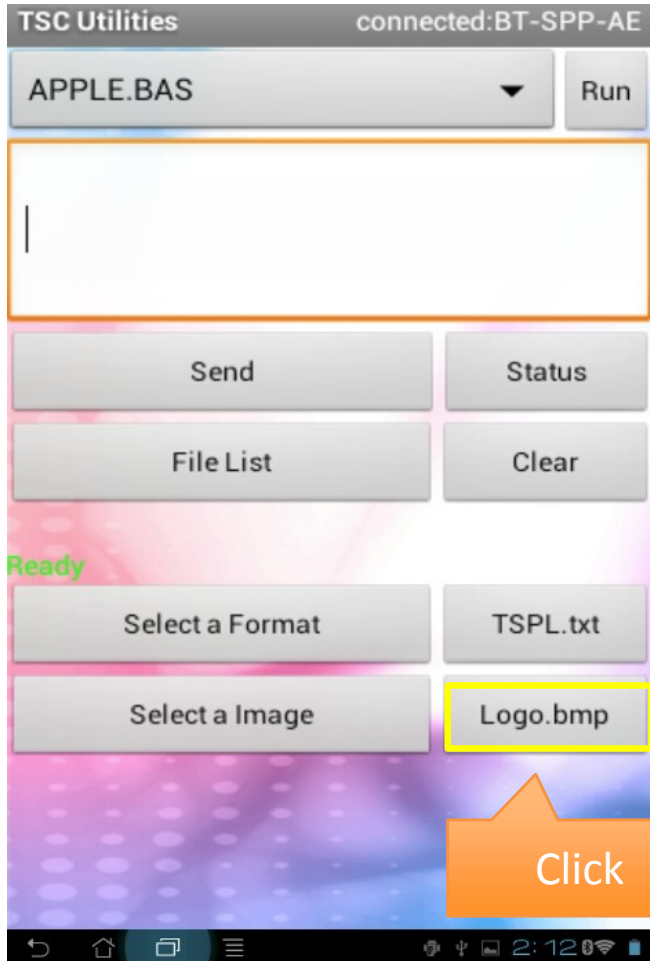

Download to
flash memory
and print





Scan Barcode Mode

Search for the Alpha-3R



Click “Scan Barcode”

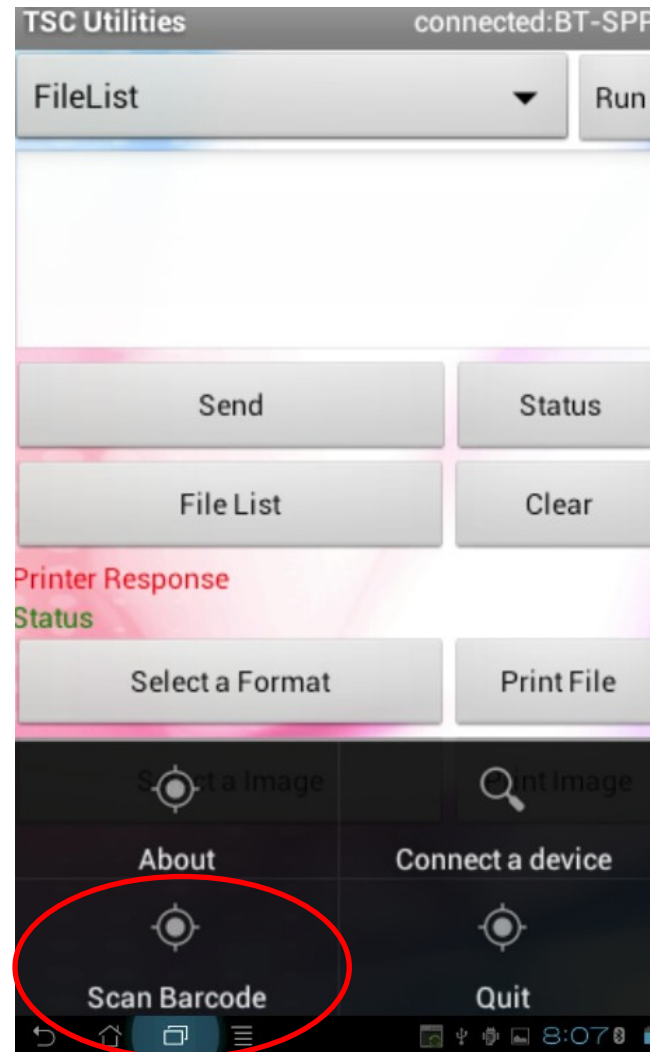

Scan the Barcode

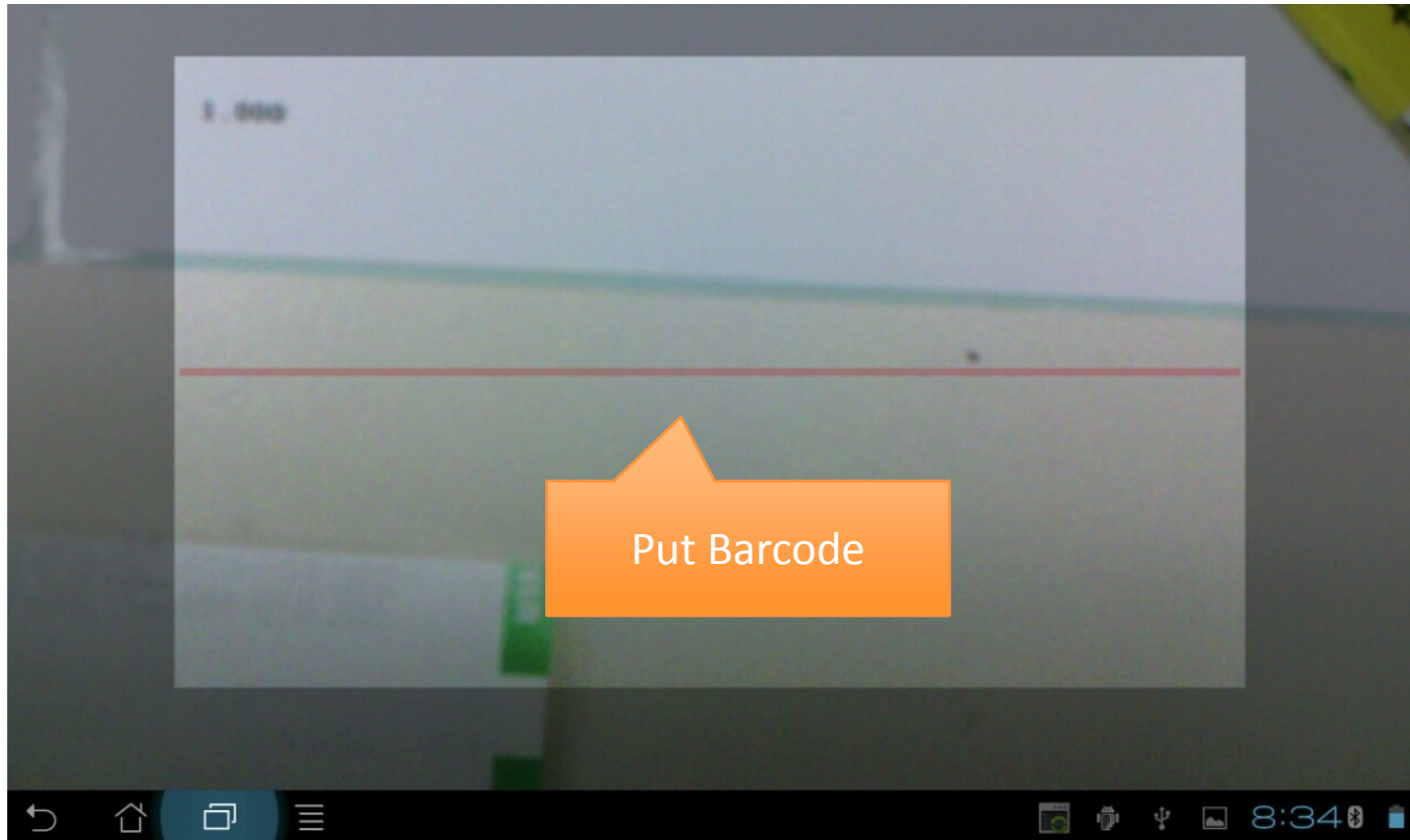

Barcode Scanner Feature

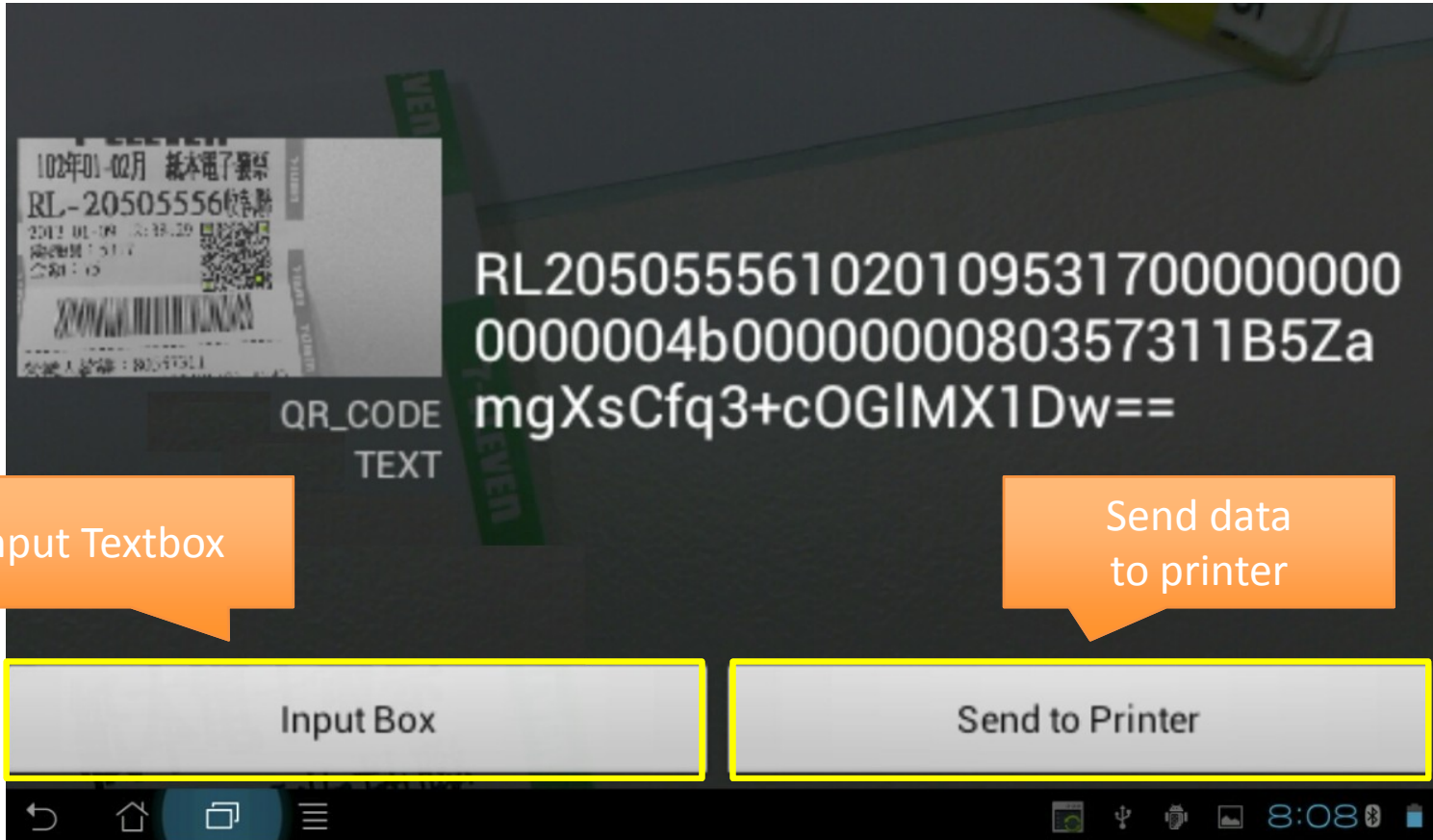



TCP/IP Mode Setup

TCP/IP Mode



Click

TSC Utilities

Bluetooth

TCP/IP



TCP/IP Mode



Input the IP Address and
Port number first

TCP/IP

IP Address : 192.168.0.1

Port : 9100

Connected

A screenshot of a handheld device's TCP/IP configuration screen. The screen has a black background with white text. At the top, it says 'TCP/IP'. Below that, there are two input fields: 'IP Address : 192.168.0.1' and 'Port : 9100'. A yellow rectangular box highlights these two fields. Below the input fields, there is a grey bar with the word 'Connected' in white. At the bottom of the screen, there is a navigation bar with several icons: a back arrow, a home icon, a copy icon, a menu icon, and a status bar showing the time '5:29' and battery level.

Enter IP Address



Thank You